

# HSF

## Recommended P.C.B Layout(Top Side) (PCB BOARD TOLERANCE±0.05)

### NOTES:

Current Rating: 3.0AMP  
 Contact Resistance: 20mΩ Max  
 Withstand Voltage: 1000V AC/DC  $\triangle A_2$   
 Insulation Resistance: 1000MΩ Min  
 Operation Temperature: -40°C to +105°C

Contact Material: Brass  $\triangle A_1$   
 Contact plating: Au Or Sn over Ni  
 Insulator Material: PA9T Or PBT+30%G.F UL94V-0

06P-18P Without Slot "A" and "B"  
 20P-58P Without Slot "A", With Slot "B"  
 60P-64P With Slot "A" and "B"

## Ordering Information

3210 - XX R XX X X X X 1

No. of Pins	Contact Plating	Insulator Color	Latch Type	Packing
06 24	G0=Gold Flash	B=Black	L=Long Latch	A=Tray
08 26	G3=10u"Gold	G=Grey(427C)	S=Short Latch	T=Tube
10 30	G4=15u"Gold		N=Without Latch	
12 34	G5=30u"Gold			
14 40	S0=Gold Flash/Tin			
16 50	S3=10u"Gold/Tin			
18 60	S4=15u"Gold/Tin			
20 64	S5=30u"Gold/Tin			
	SN=Tin			

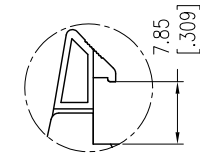
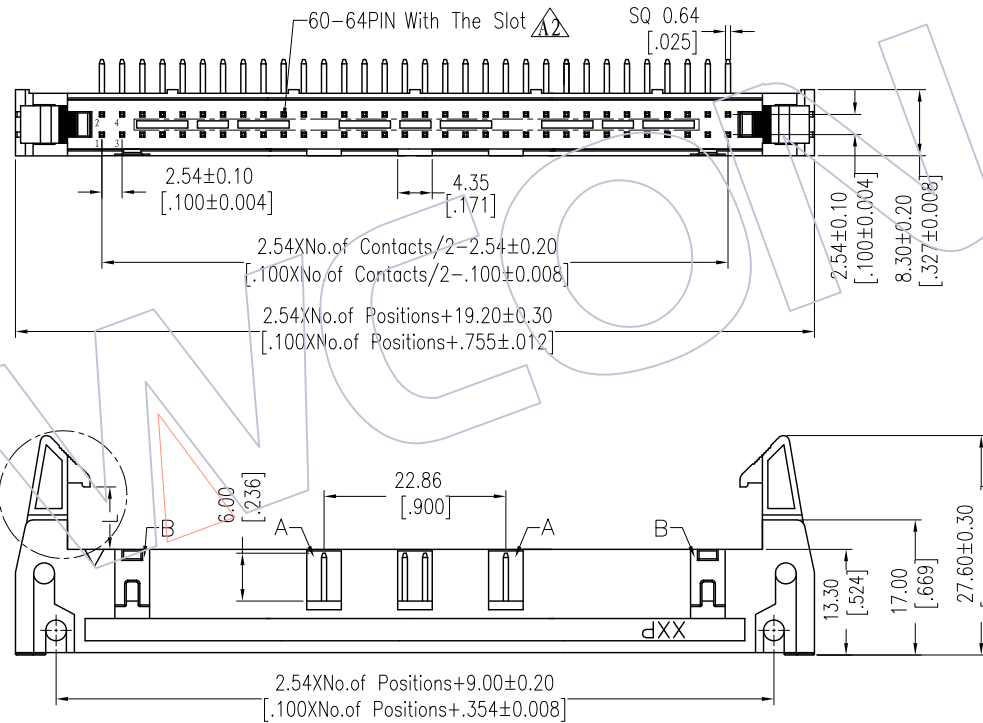
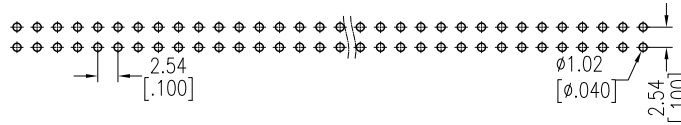

Long Latch

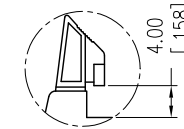

Short Latch

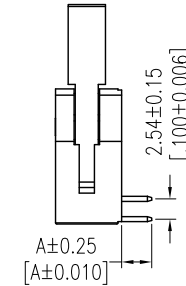

Item	Pitch	Mating
Standard	2.54	5211
Alternate		

Item	DIM.A
Standard	3.80
Alternate	---

REV	DATE	MODIFICATION DESCRIPTION	CHANGE	OPERATION	DRAW	DATE	SCALE	FIT	PART NO.
A3	2014/12/03	MODIFY	$\triangle A_3$	OPERATION	Allen	2014/12/03	UNIT	mm	3210-XXRXXXXX1
A2	2013/02/25	MODIFY	$\triangle A_2$	x.X ±0.40	CHECK		SHEET	1/1	TITLE:
A1	2012/12/19	MODIFY THE MATERIAL	$\triangle A_1$	x.XX ±0.25	APPROVE		PROJ.	$\phi$	2.54 EJECTOR HEADER 90° DIP
A0	2012/10/08	NEW	---	x.XXX ±0.15					Customer NO.
				Angle ± 3'					
				DIM TOL					



Http: [www.wcon.com](http://www.wcon.com)

WCON-Dongguan Tel: +86 769 85358920 Fax: +86 769 85358915 E-mail: <a href="mailto:sales@wcon.com">sales@wcon.com</a>	WCON-Kunshan Tel: +86 512 57468408 Fax: +86 512 57468468 E-mail: <a href="mailto:salesks@wcon.com">salesks@wcon.com</a>
---	--